

The Ashtons logo is displayed in white text on a dark blue rectangular background in the top right corner. The word "Ashtons" is in a sans-serif font, with a green leaf-like graphic element integrated into the letter 'A'.

Ashtons

503 Ryedale House Piccadilly YO1 9NX

£2,300 Per Calendar Month

2



2



1



B



A fine example of city centre apartment living, Ryedale House is an exclusive, private development in the heart of the city centre with impressive lobby warded by an on site concierge and secure allocated parking. The fifth floor apartment is finished to a high standard and offered on a furnished basis. Arrive into the apartment's entrance hallway, leading to an open plan living kitchen space with floor to ceiling windows looking out to Clifford's Tower. The contemporary kitchen is well considered, equipped with integrated fridge freezer, oven, hob and dishwasher with washing machine stowed in a utility cupboard. From the living space you can access the balcony; one of a minority of units within the development to have this, offering a delightful sitting area with views over the Tower and River Foss. There are two double bedrooms, both with access to the balcony area, and the primary bedroom benefitting from sitting area and an ensuite bathroom with overhead shower. There is a further shower room accessed off the hallway. Underfloor heating has been installed throughout the apartment and there is an allocated parking space in a gated private car park to the rear of the building.

Available from 25th September / 6-12 Month Tenancies Available / Deposit £2400 / Council Tax Band E / EPC Rating B / One Allocated Parking Space

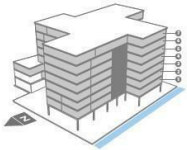

Apartments	
Floor 1: 1.4	Floor 4: 4.3
Floor 2: 2.4	Floor 5: 5.3
Floor 3: 3.3	Floor 6: 6.3



Ashtons Lettings

01904 731404

lettings@ashtonsnet.com

